

# A8P

New Generation Bent Axis Pumps

# A8P

## Bent Axis Pumps

25cc, 32cc, 40cc, 50cc, 63cc,  
80cc, 108cc and 130cc...

## High Rotational Speed



**Bent Axis Pumps**

A8P

# A8P

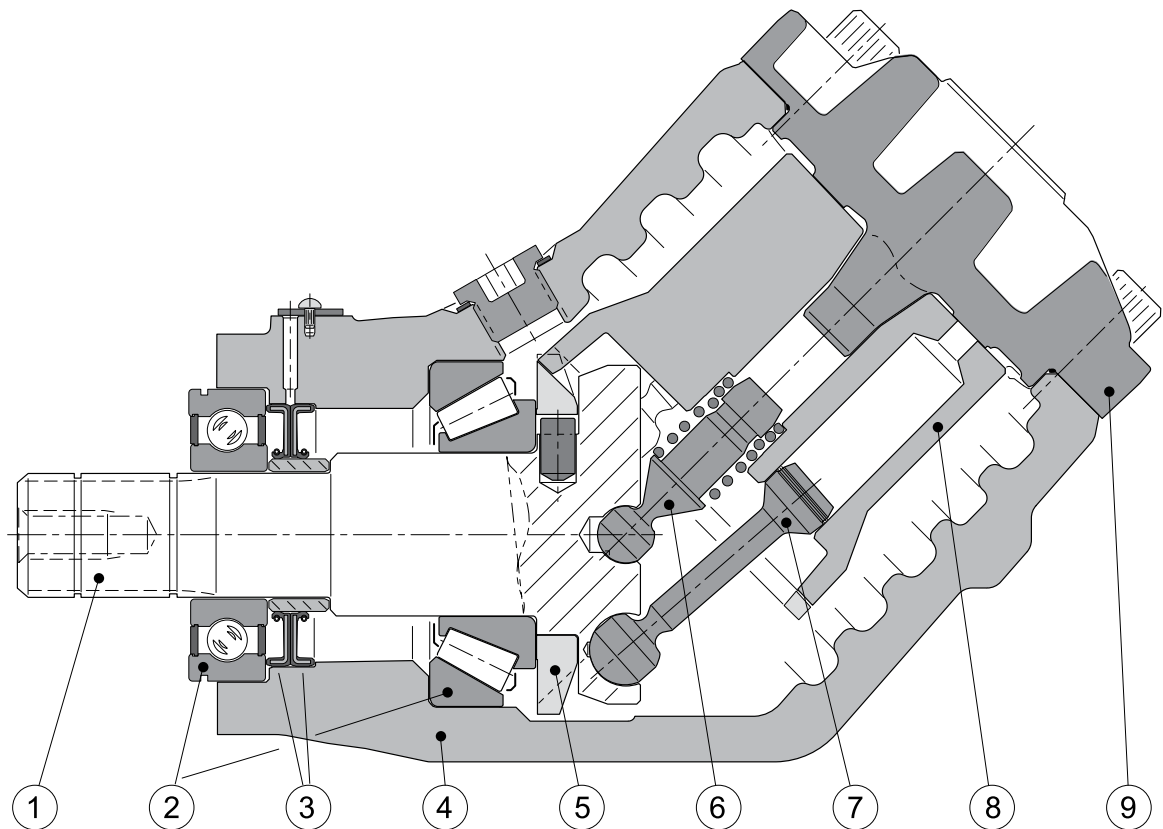

- |                |                   |                            |
|----------------|-------------------|----------------------------|
| 1. Input shaft | 4. Housing        | 7. Piston with piston ring |
| 2. Bearings    | 5. Timing gear    | 8. Cylinder barrel         |
| 3. Shaft seals | 6. Barrel support | 9. End cap                 |

| Frame size                                 | 25      | 41      | 51      | 61      | 81                 | 101                |
|--|---------|---------|---------|---------|--------------------|--------------------|
| <b>Displacement</b> [cm <sup>3</sup> /rev] | 25.6    | 40.9    | 51.1    | 59.5    | 81.6               | 102.9              |
| <b>Max flow</b> <sup>1)</sup> [l/min]      | 67      | 98      | 112     | 131     | 163 <sup>3)</sup>  | 185 <sup>3)</sup>  |
| <b>Max operating pressure</b> [bar]        | 400     | 400     | 400     | 400     | 400                | 400                |
| <b>Mass moment of inertia J</b> [kgm]      | 0,00274 | 0,00266 | 0,00261 | 0,00257 | 0,00532            | 0,00524            |
| <b>Shaft speed</b> [rpm]                   | 2700    | 2700    | 2700    | 2700    | 2300               | 2300               |
| - max speed at 350 bar                     | 2600    | 2400    | 2200    | 2200    | 2000 <sup>3)</sup> | 1800 <sup>3)</sup> |
| <b>Torque</b> <sup>1)</sup> [Nm]           | 163     | 260     | 324     | 378     | 518                | 653                |
| <b>Input power</b> [kW]                    | 39      | 57      | 66      | 76      | 95                 | 108                |
| <b>Weight</b> [kg]                         | 8.5     | 8.5     | 8.5     | 8.5     | 12.5               | 12.5               |

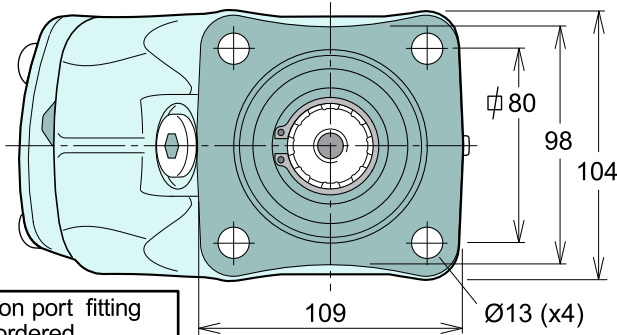

NOTE! The suction port fitting must be ordered separately

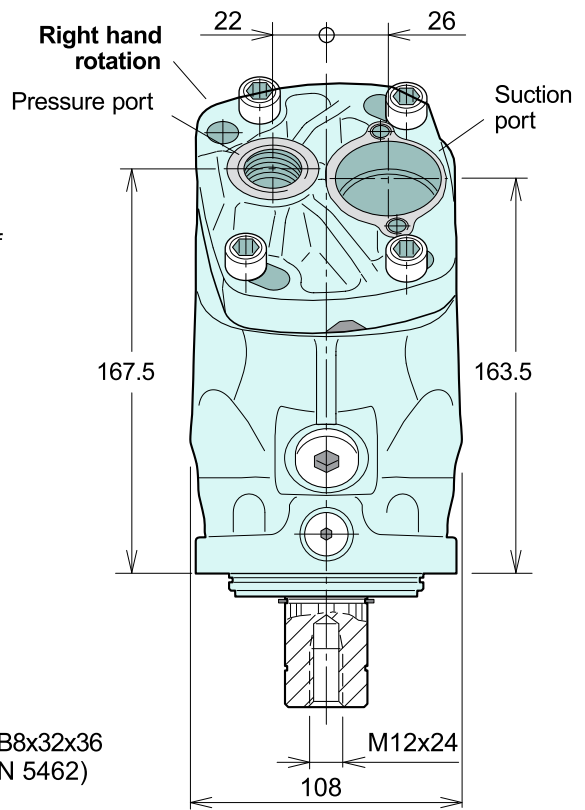
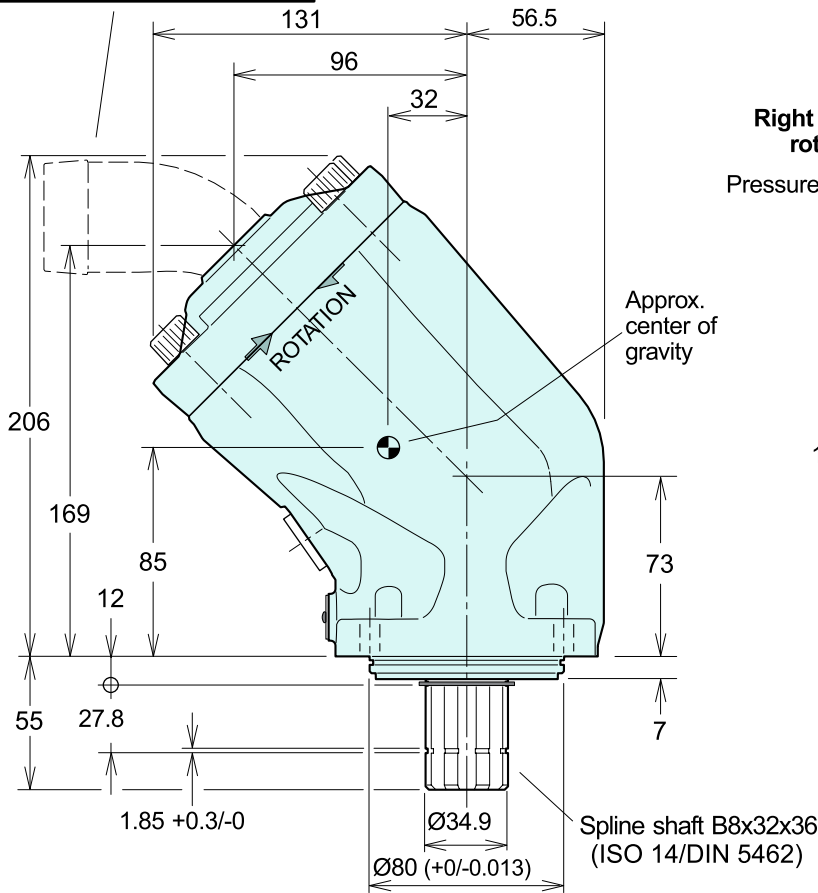
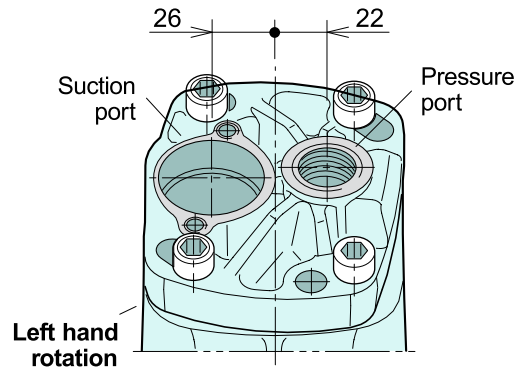

### Ordering code

Example:

**A8P - 81 - R**

**A8P** frame size  
25, 41, 51, 61, 81 or 101

Shaft rotation  
**R** Righthand  
**L** Left hand

### Standard versions

| Designation     | Ordering no. |
|-----------------|--------------|
| <b>A8P-25-R</b> | 378 1024     |
| <b>A8P-25-L</b> | 378 1025     |
| <b>A8P-41-R</b> | 378 1040     |
| <b>A8P-41-L</b> | 378 1041     |
| <b>A8P-51-R</b> | 378 1050     |
| <b>A8P-51-L</b> | 378 1051     |
| <b>A8P-61-R</b> | 378 1060     |
| <b>A8P-61-L</b> | 378 1061     |

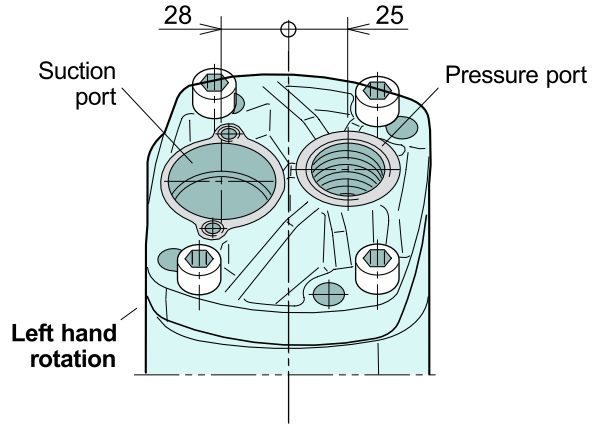
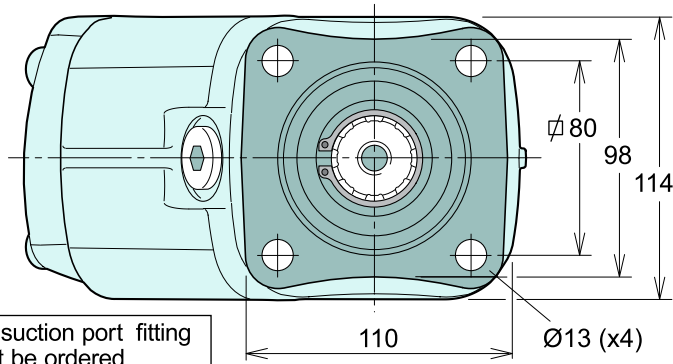

NOTE! The suction port fitting must be ordered separately

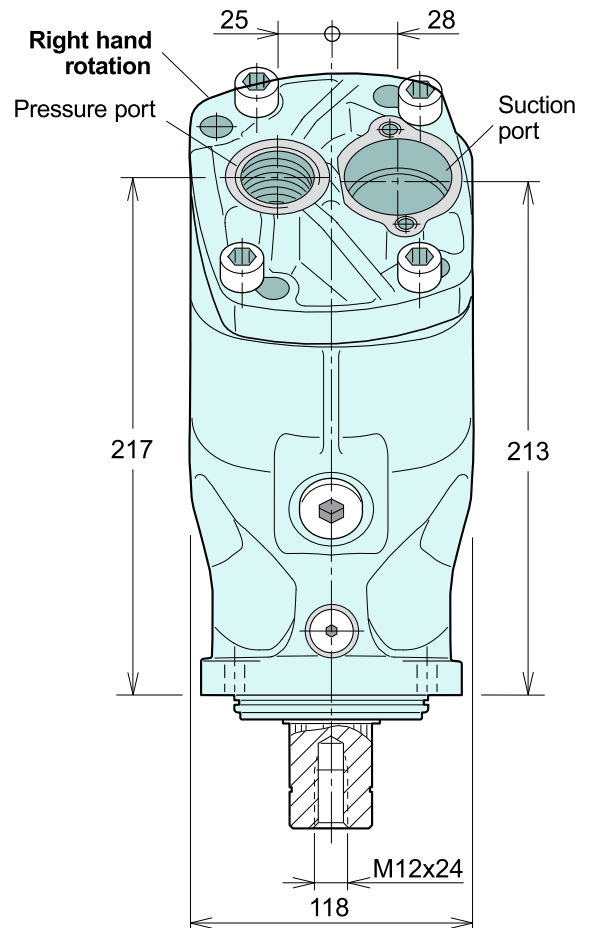
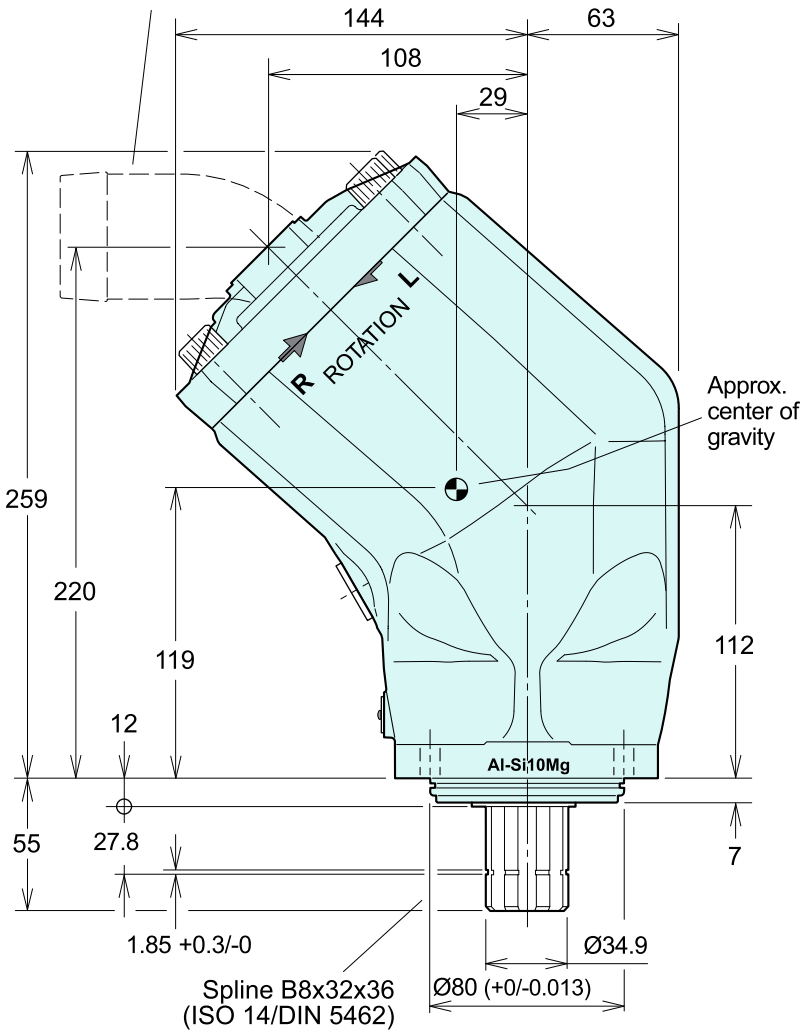

### Port size

| frame size | Pressure port <sup>1)</sup> |
|------------|-----------------------------|
| -25        | 3/4"                        |
| -41        | 3/4"                        |
| -51        | 3/4"                        |
| -61        | 3/4"                        |
| -81        | 1"                          |
| -101       | 1"                          |

### Standard versions

| Designation | Ordering no. |
|-------------|--------------|
| -81-R       | 378 1080     |
| -81-L       | 378 1081     |
| -101-R      | 378 1100     |
| -101-L      | 378 1101     |

Only on the prototypes!

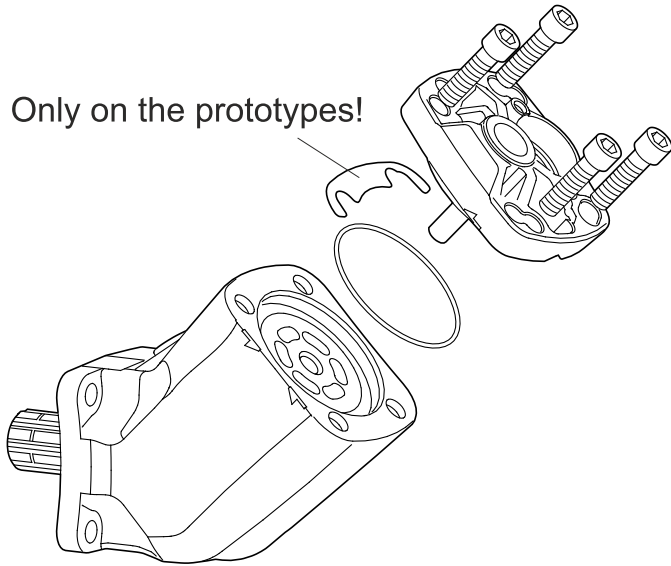

4.  
Disassemble the end cap.

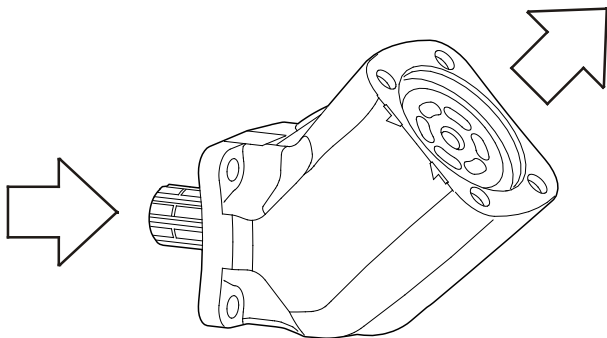

5.  
Take out the shaft, the pistons, the barrel support and the cylinder barrel from the barrel housing. Disassemble the cassette seal from the barrel housing.

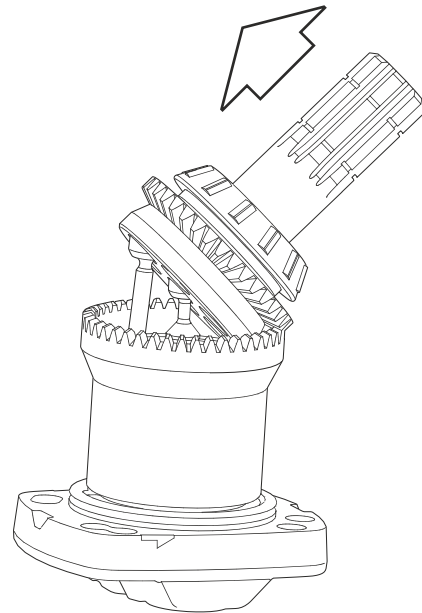

Bild\_5.eps  
Leif A./981126

6.  
Angle the shaft up and disassemble it together with pistons and barrel support. The barrel support is kept in position in the barrel with a snap function.

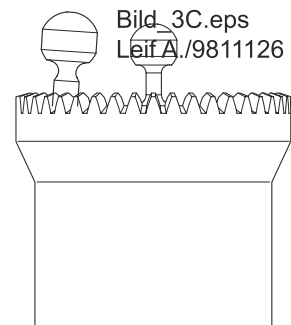
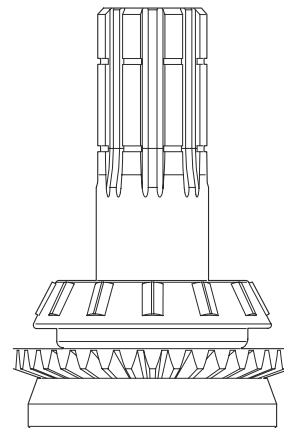

Bild\_3C.eps  
Leif A./981126

## Assembling

1. Fasten the end cap in a vice with the center shaft upwards.

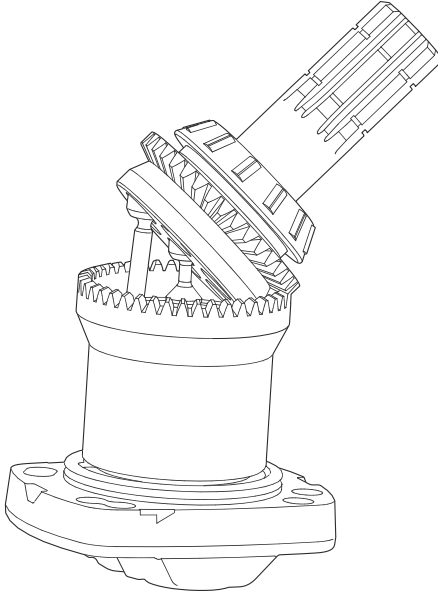

Bild\_5.eps  
Leif A./981126

2. Place the pistons and the barrel support in the cylinder barrel. Place the shaft over the pistons and on the barrel support. Turn the package 180° and shake down the pistons into the piston holes in the shaft, then angle 45°. Turn the package back and reassemble the cylinder barrel on the end cap. Ensure correct timing. (Marking, punch mark)

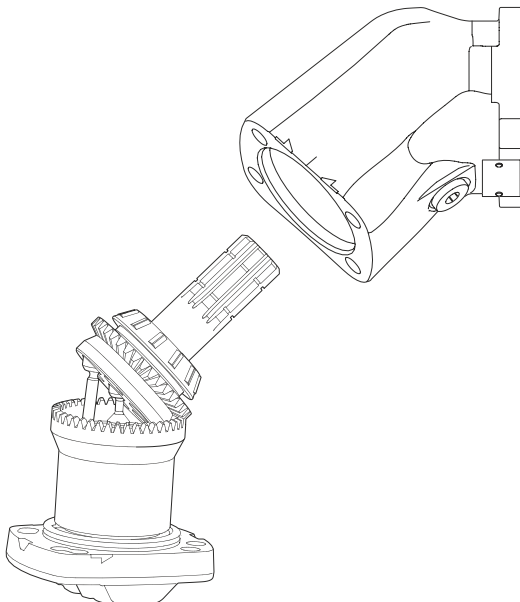

Bild\_5.eps  
Leif A./981126

3. Reassemble the barrel housing. Ensure correct rotation. Tighten at least two screws. Check the timing by rotating the shaft. The timing is easy to check under the purge plugg in the housing.

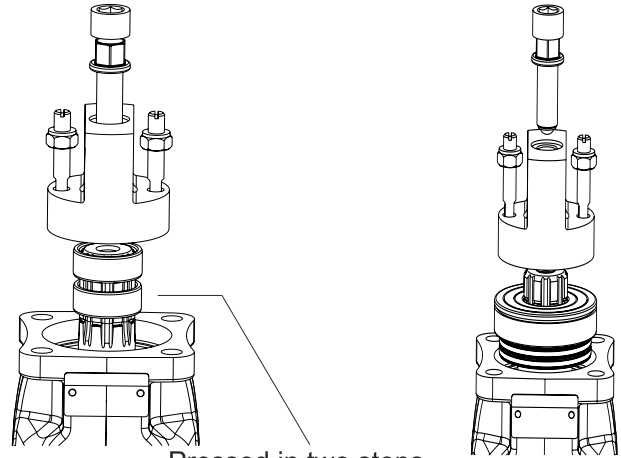

Pressed in two steps.  
See below in text!!

4. Fasten the package in a vice with the shaft end upwards. Place the inner ring on to the shaft. The inner ring is pressed down in two steps. First step with the assemble tool alone. Second step with assemble tool together with the distance ring to reach final position for the inner ring. Lubricate the outer diameter of the cassette seal with hydraulic oil. Place the cassette seal together with the bearing on to the shaft. Take the assembly tool and place it on the bearing. Fasten the assembly screw a couple of turns. Pull down the bearing together with cassette seal by turning the nut as far as possible. Reassemble the protective washer (item 465), the waved spring washer (item 238) and the retaining ring (item 465) if necessary (see publ. 1780). Fasten all screws and make sure that correct torque is achieved. (90±10Nm)

Turn the shaft  
at least on rev.  
to ensure correct  
mounting.

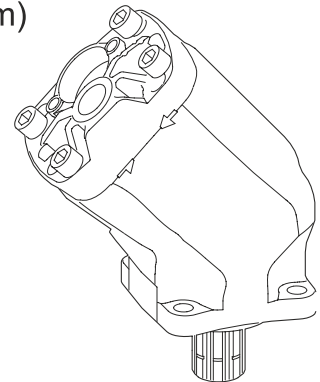



## Splitview / Spare Parts

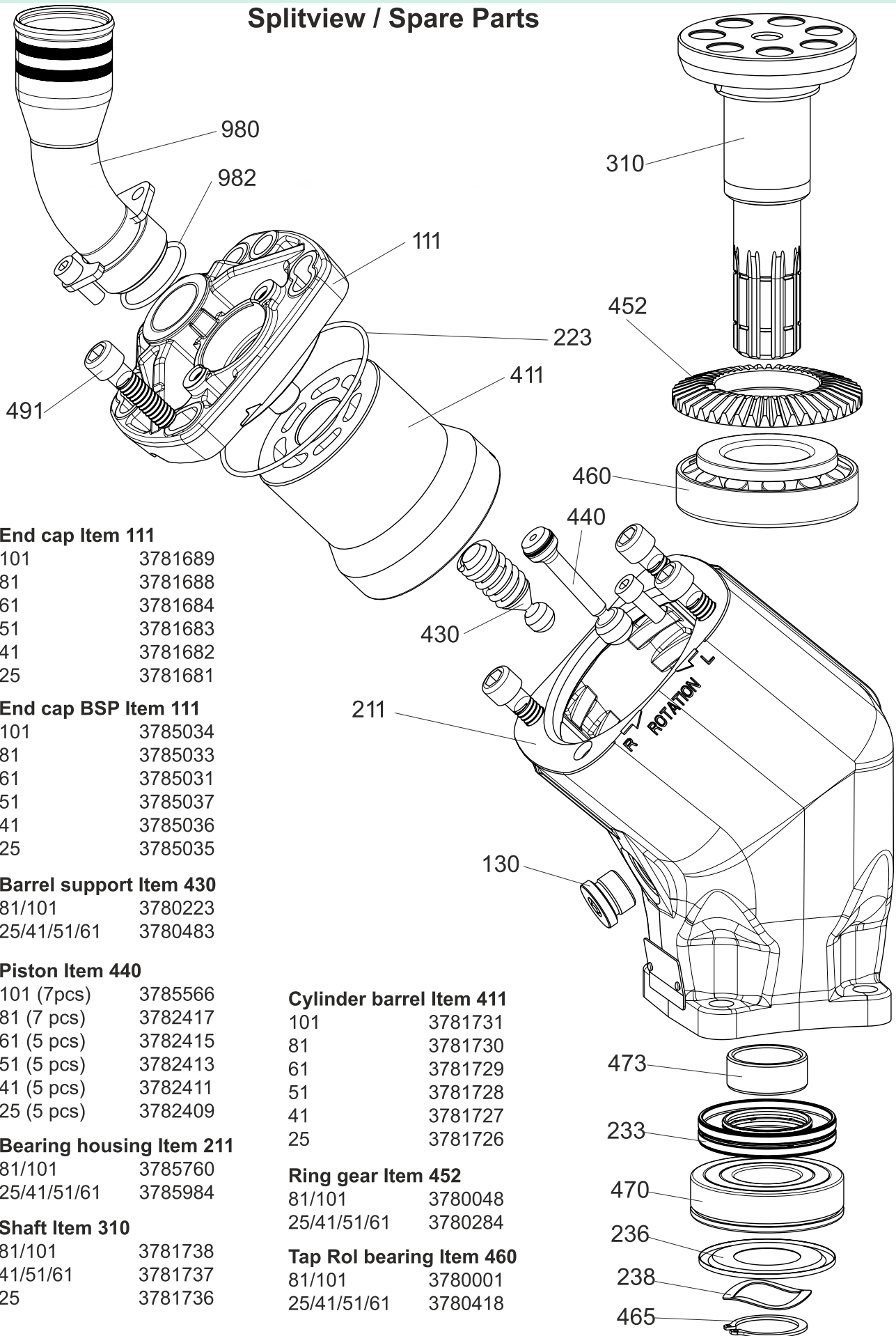

### End cap Item 111

|     |         |
|-----|---------|
| 101 | 3781689 |
| 81  | 3781688 |
| 61  | 3781684 |
| 51  | 3781683 |
| 41  | 3781682 |
| 25  | 3781681 |

### End cap BSP Item 111

|     |         |
|-----|---------|
| 101 | 3785034 |
| 81  | 3785033 |
| 61  | 3785031 |
| 51  | 3785037 |
| 41  | 3785036 |
| 25  | 3785035 |

### Barrel support Item 430

|             |         |
|-------------|---------|
| 81/101      | 3780223 |
| 25/41/51/61 | 3780483 |

### Piston Item 440

|            |         |
|------------|---------|
| 101 (7pcs) | 3785566 |
| 81 (7 pcs) | 3782417 |
| 61 (5 pcs) | 3782415 |
| 51 (5 pcs) | 3782413 |
| 41 (5 pcs) | 3782411 |
| 25 (5 pcs) | 3782409 |

### Bearing housing Item 211

|             |         |
|-------------|---------|
| 81/101      | 3785760 |
| 25/41/51/61 | 3785984 |

### Shaft Item 310

|          |         |
|----------|---------|
| 81/101   | 3781738 |
| 41/51/61 | 3781737 |
| 25       | 3781736 |

### Cylinder barrel Item 411

|     |         |
|-----|---------|
| 101 | 3781731 |
| 81  | 3781730 |
| 61  | 3781729 |
| 51  | 3781728 |
| 41  | 3781727 |
| 25  | 3781726 |

### Ring gear Item 452

|             |         |
|-------------|---------|
| 81/101      | 3780048 |
| 25/41/51/61 | 3780284 |

### Tap Rol bearing Item 460

|             |         |
|-------------|---------|
| 81/101      | 3780001 |
| 25/41/51/61 | 3780418 |

## Splitview / Spare Parts GP1 Motor

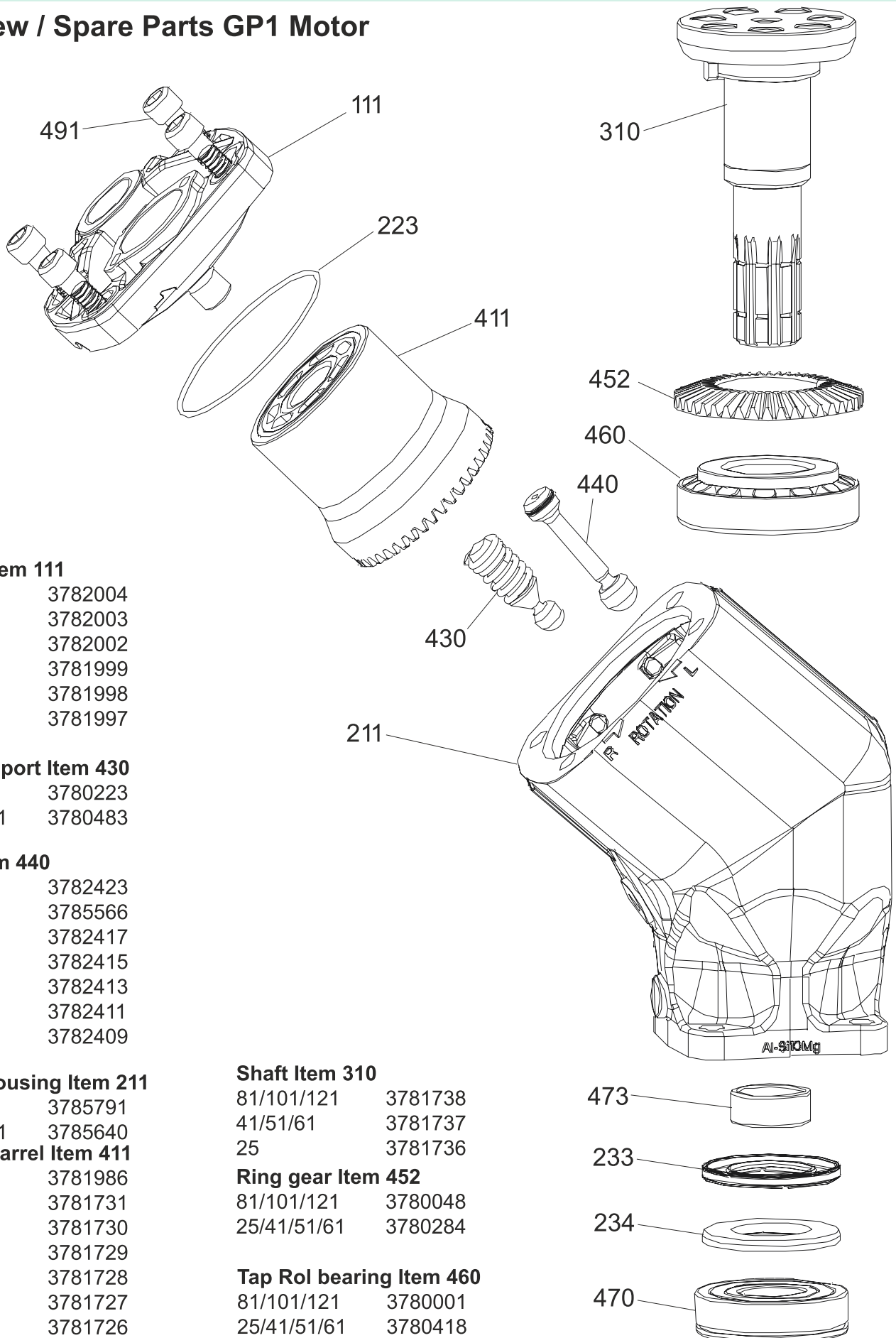

### End cap Item 111

|     |         |
|-----|---------|
| 101 | 3782004 |
| 81  | 3782003 |
| 61  | 3782002 |
| 51  | 3781999 |
| 41  | 3781998 |
| 25  | 3781997 |

### Barrel support Item 430

|             |         |
|-------------|---------|
| 81/101/121  | 3780223 |
| 25/41/51/61 | 3780483 |

### Piston Item 440

|     |         |
|-----|---------|
| 121 | 3782423 |
| 101 | 3785566 |
| 81  | 3782417 |
| 61  | 3782415 |
| 51  | 3782413 |
| 41  | 3782411 |
| 25  | 3782409 |

### Bearing housing Item 211

|             |         |
|-------------|---------|
| 81/101/121  | 3785791 |
| 25/41/51/61 | 3785640 |

### Cylinder barrel Item 411

|     |         |
|-----|---------|
| 121 | 3781986 |
| 101 | 3781731 |
| 81  | 3781730 |
| 61  | 3781729 |
| 51  | 3781728 |
| 41  | 3781727 |
| 25  | 3781726 |

### Shaft Item 310

|            |         |
|------------|---------|
| 81/101/121 | 3781738 |
| 41/51/61   | 3781737 |
| 25         | 3781736 |

### Ring gear Item 452

|             |         |
|-------------|---------|
| 81/101/121  | 3780048 |
| 25/41/51/61 | 3780284 |

### Tap Rol bearing Item 460

|             |         |
|-------------|---------|
| 81/101/121  | 3780001 |
| 25/41/51/61 | 3780418 |

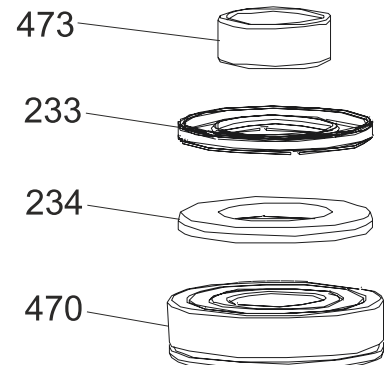



# Complete Product Range

## Piston Pumps

## Piston Motors

# DIN

DIN 5462 / ISO 14  
8x32x35  
8x32x36  
DIN 6885



**A8PD**



**A9MD**

# ISO

ISO 3019-2 (4 BOLTS)  
DIN 5480 -W25,30,35,40,45  
DIN 6885 -Ø20,25,30,35,40,45



**A8PO**



**A9MO**

# SAE

SAE B2 C4 - SAE D  
SAE J498b  
SAE J 744



**A8PS**



**A9MS**

# M2

Fixed Plug-in

DIN 5480 / ISO 3019-2  
W30 - W35 - W40  
M21 - M22 - M23



**A8PL - Dual Flow**

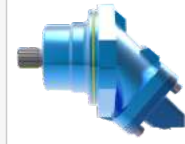

**A9MF - Semi integrated**

# A4

DIN ISO 14  
8x32x36



**A4PP Single Flow**



**A4PL Dual Flow**

# A6

P2 Connection M8x125  
Woodruff key 3x6,5 NF E  
27-653 NF R 124-04  
(2 BOLTS)



**A6HP - High Pressure**



**A7GP - Gear Pump  
A7GM - Gear Motor**

# Contact



Gold Hydraulics, Ltd.

2019® Catalogue

All pictures and banners are patented by owner.

[www.goldhydraulics.com](http://www.goldhydraulics.com)

For more details and other catalogs,  
please send email to our team.

Hydraulic Bent Axis Piston Pumps  
Bent Axis Motors  
Dual Flow Piston Pumps and Gear Pumps...

Sales Team

[info@goldhydraulics.com](mailto:info@goldhydraulics.com)

Order

[order@goldhydraulics.com](mailto:order@goldhydraulics.com)

Management

[mail@goldhydraulics.com](mailto:mail@goldhydraulics.com)



[www.goldhydraulics.com](http://www.goldhydraulics.com)